



Feature -

- Small size
- LED illuminated ,
- Two color available
- Long life

Applications -

- Consumer Products
- Instrumentation
- Computer Products
- Communication Equipments

► SPECIFICATIONS

| SWITCH SPECIFICATIONS | |
|-----------------------------|---|
| POLE - POSITION | 1P1T , with LED |
| CONTACT RATING | 12 V DC , 50 mA |
| CONTACT RESISTANCE | 100 mΩ max . 1.5 V DC ; 100 mA , by Method of Voltage DROP |
| INSULATION RESISTANCE | 100 MΩ min . 500 V DC |
| DIELECTRIC STRENGTH | Breakdown is not Allowable ; 500 V AC for 1 Minute |
| OPERATING FORCE | 180 ± 50 gf |
| OPERATING LIFE | 500,000 cycles |
| OPERATING TEMPERATURE RANGE | -20°C ~ 70°C |
| TOTAL TRAVEL | 0.2 ± 0.1 mm |

| LED SPECIFICATIONS | | | | | | | |
|---|------|-------------------|------------------|---------|---------|--------------|---------|
| ATTENTION LEDs are Electrostatic Sensitive devices | Unit | Value / LED Color | | | | | |
| | | Blue | Green | Red | White | Yellow | |
| FORWARD CURRENT | If | mA | 30 | 30 | 15 | 30 | 20 |
| REVERSE VOLTAGE | Vr | V | 5.0 | 5.0 | 5.0 | 5.0 | 5.0 |
| REVERSE CURRENT | Ir | μA | 10 | 10 | 10 | 10 | 10 |
| FORWARD VOLTAGE@20mA | Vf | V | 3.5-4.0 | 1.7-2.8 | 1.7-2.8 | 3.3-3.8 | 1.7-2.8 |
| LUMINOUS INTENSITY@10mA | Iv | mcd | @20mA 180-245 | 24-40 | 4.0-7.0 | @20mA 145 | 18-30 |

■ Physical and electrical information of LED will be provided upon customer's request on switches .

► HOW TO ORDER

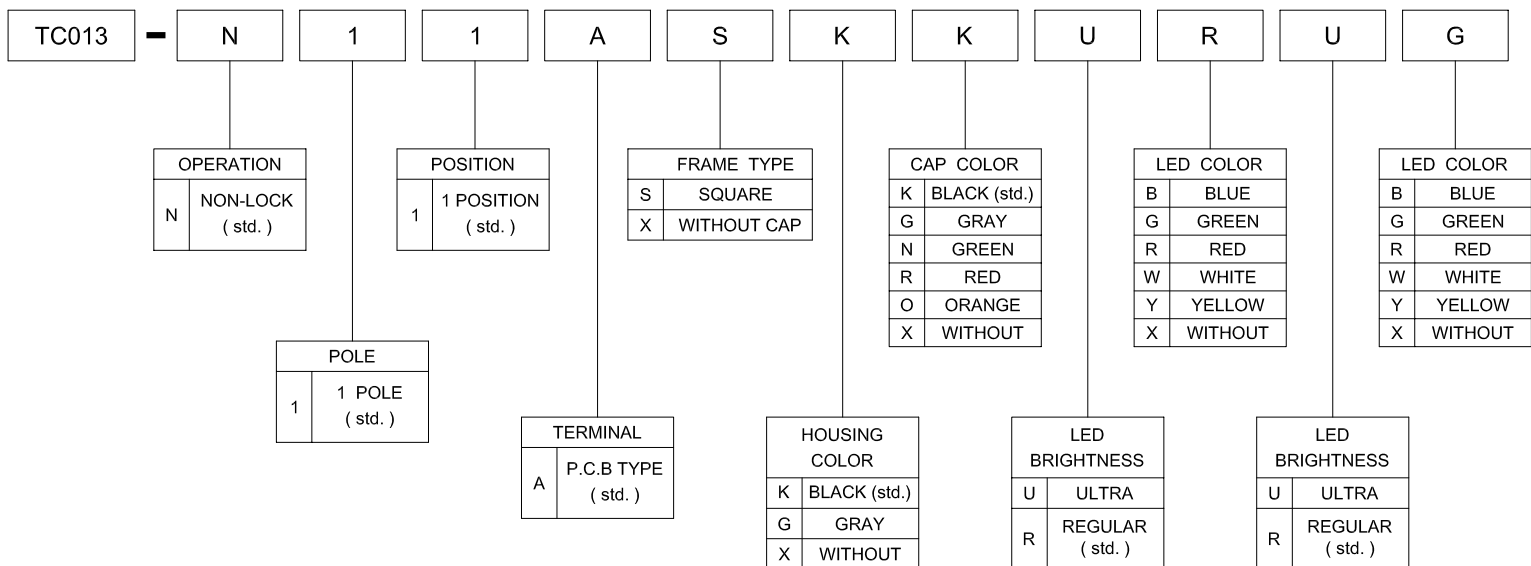

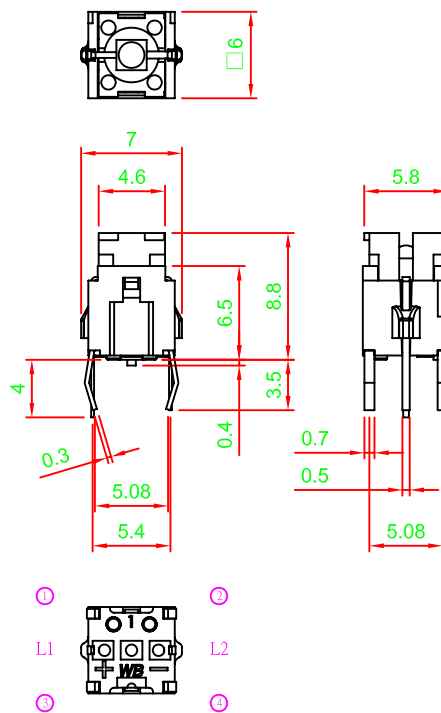

► **DIMENSION**

TC013-N11AXXX □ □ □ □

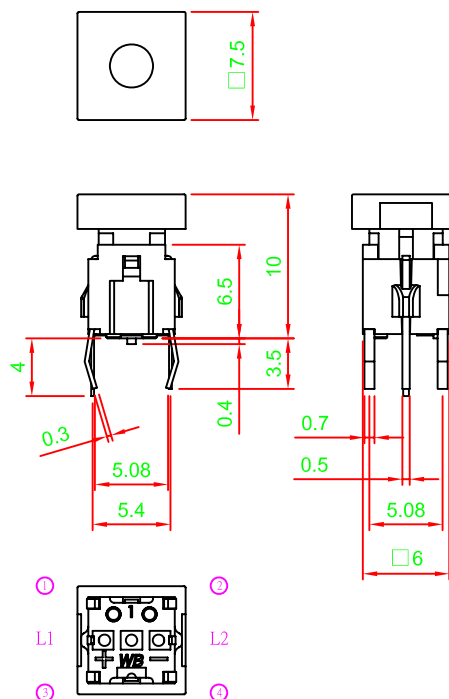

TC013-N11ASXK □ □ □ □

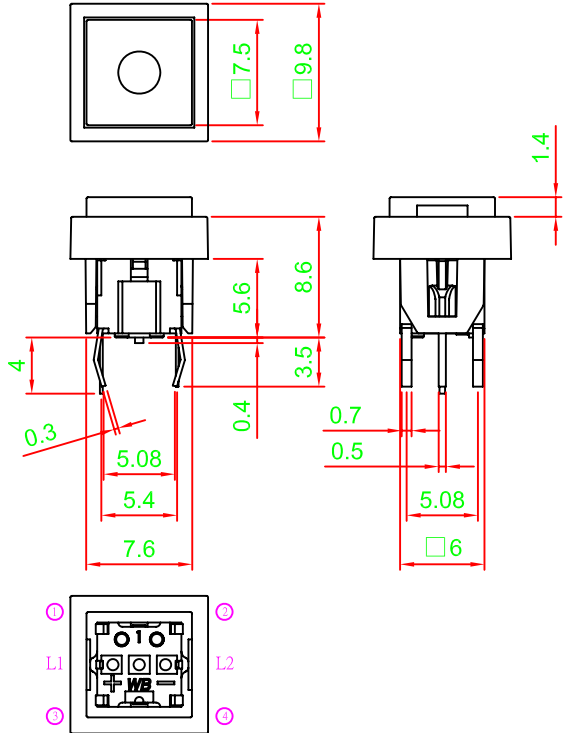
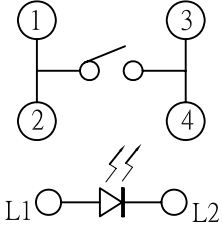
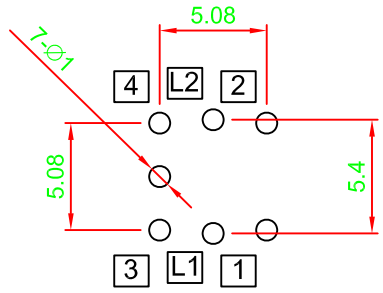

| | |
|--|---|
| <p>► DIMENSION</p> | |
| <p>TC013-N11ASKK □□□□</p>  |  |
| <p>► CIRCUIT</p>  | <p>► P.C.B LAYOUT</p>  |
| <p>► MATERIAL</p> <ul style="list-style-type: none"> ■ COVER - PA ■ ACTUATOR - PBT + GF ■ BASE FRAME - PA + GF ■ TERMINAL - BRASS SILVER PLATING | <p>► UNIT WEIGHT</p> <ul style="list-style-type: none"> ■ TC013-N11AXXX □□□□ : 0.35 ± 0.05 g / pcs ■ TC013-N11ASXK □□□□ : 0.45 ± 0.05 g / pcs ■ TC013-N11ASKK □□□□ : 0.65 ± 0.05 g / pcs |